

Summary of Design Changes

Since the Public Exhibition in November 2018, Richards Music Centre has been subject to reviews by Haringey Council through their Pre-Application process and a Quality Review Panel. The key points raised at these meetings have been summarised below, with further information on the boards showing how the design has evolved to address comments.

Richards Music Centre - What has been said

Comments were made that the boundary condition with Bishopswood Road could engage more positively with the street.

It was felt that the west elevation should engage with the street more strongly.

Richards Music Centre - What we have done

The existing fence and gates have been replaced to provide a more sensitive boundary condition mediating between the playing fields and the adjacent residential properties. A low brick wall provides a sense of enclosure to external areas and planting has been included to soften the boundary edge.

More visual interest has been provided to the west elevation with increased fenestration and niches. The building name and coat of arms has been added and the roof eaves have been increased.

It is important the western edge of the Richards Music Centre adequately addresses the street to sensitively sit within its context and provide a suitable welcoming experience into the building.

Key comment:

1. The previous plan did not include any proposed amendments to the boundary condition with the existing fence and vehicle gates formerly to be retained

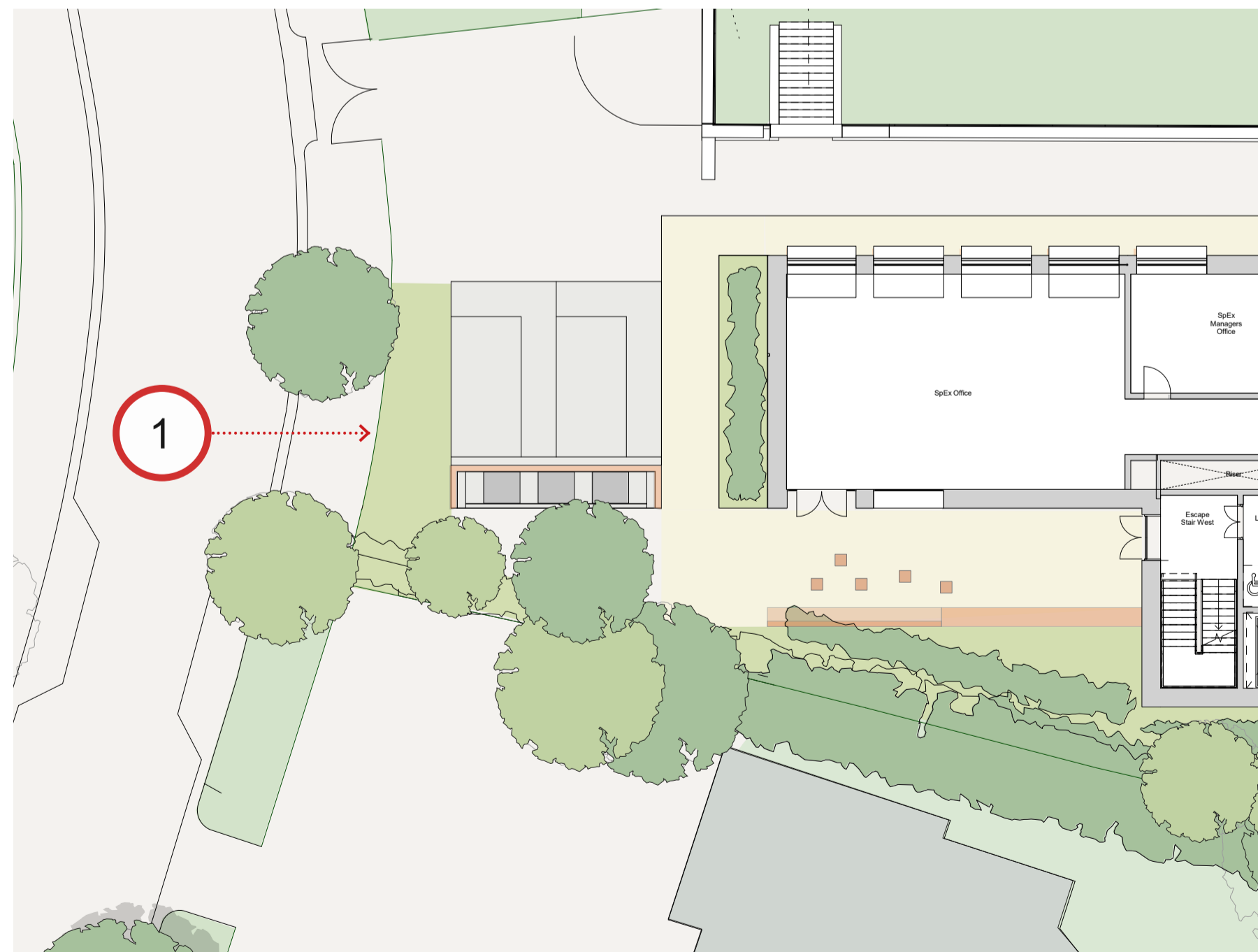

Previous Boundary Condition

Key changes:

1. New vehicle & pedestrian gates
2. Fence replaced with brickwork piers with railings
3. Formal boundary edge planting with low brick container wall
4. Parking / refuse area defined by new brick wall
5. Staff garden screened with brick wall

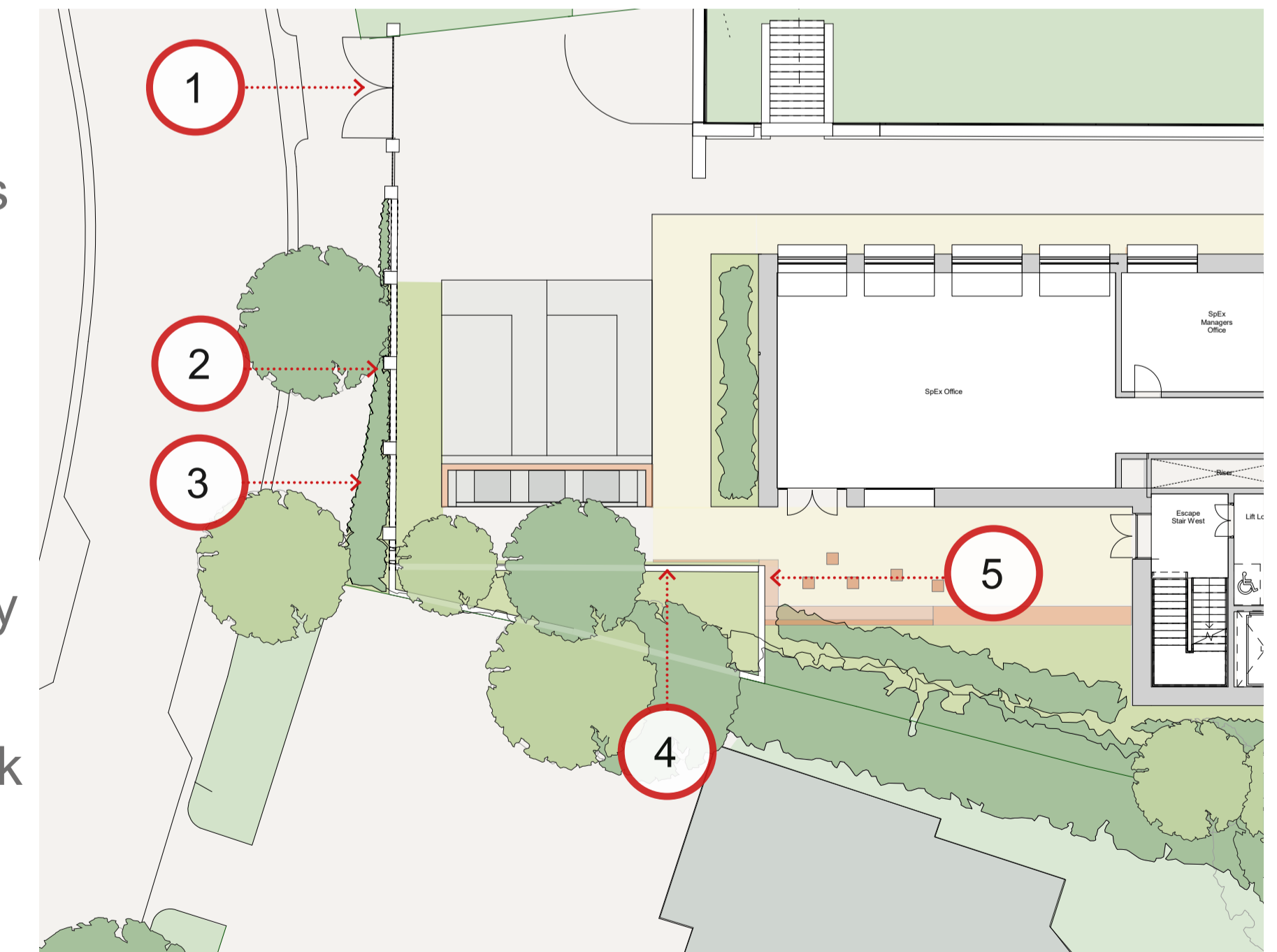

Updated Boundary Condition

Bishopswood Road Facade and Boundary Condition

Key changes:

- 1. New vehicle & pedestrian gates
- 2. New railings set between solid brick piers
- 3. Formal boundary edge planting with low container wall
- 4. Vertical recess to divide brick wall panels
- 5. Enlarged sculptural School crest, set into brickwork recess
- 6. New window opening to escape stair
- 7. Roof eaves extended

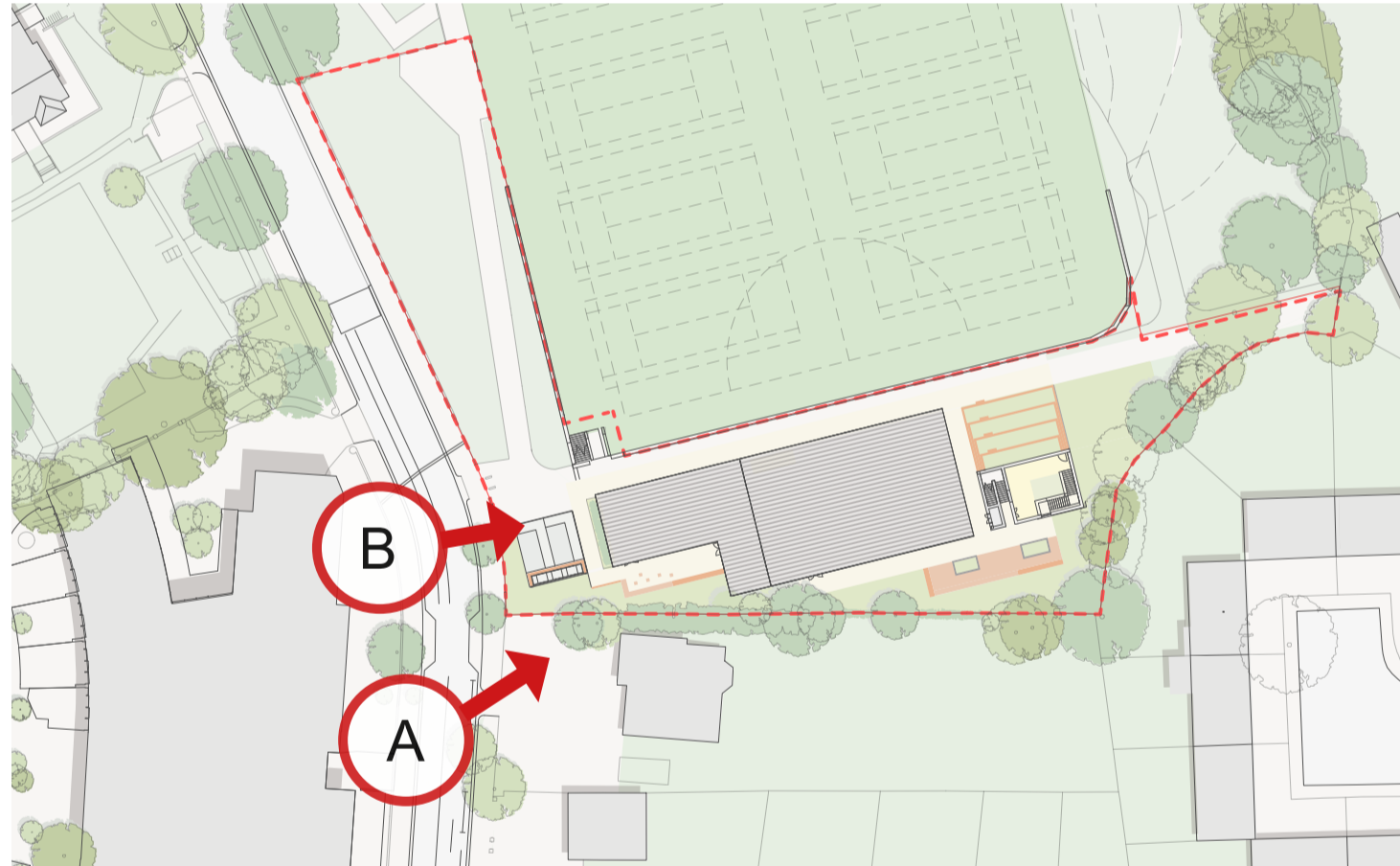

West Elevation from Bishopswood Road



View A - Previous



View A - Updated



View B - Previous



View B - Updated